

**USER'S MANUAL
MANUAL DE USUARIO
MANUEL D'UTILISATION
GEBRAUCHSANWEISUNG
GEBRUIKSAANWIJZING
MANUALE D'USO
MANUAL DO UTILIZADOR
BRUKSANVISNING**

Spiuk[®]



This user's manual forms an integral part of the product purchased. We advise you to keep it for the life of your SPIUK helmet.

Read these instructions carefully before wearing your new helmet. A failure to comply with these warnings could pose a serious risk to your safety, and also void the SPIUK warranty.

1. This helmet has been tested and approved according to CE-EN 1078:2012+A1:2012 "Helmets for cyclists and for users of skateboards and roller skates". EU Declaration of Conformity certificates per Regulation 2016/425 are available at the following link: www.spiuk.com/en/homologations
2. However, it cannot be worn in extreme activities like downhill riding at high speed, jumping on the bicycle if the two wheels lift off the ground, ice sports, water sports, motorsports, roller hockey, activities in children's playgrounds or others that require face or ear protection, or higher levels of protection.
3. Children should never wear the helmet while climbing, for instance, as the strap might choke them.
4. This helmet protects the head on impact; however, it does not protect the cervical spine, the vertebral column or other parts of the body. Some types of head damage cannot be prevented by any helmet. Severe injuries can occur even in low-speed crashes.
5. The helmet can only protect if it fits well. The buyer should try different sizes and choose the size which feels secure and comfortable on the head.
6. A helmet subjected to a severe impact should be discarded and destroyed; even if you do not see any damage.
7. This helmet is made of expanded polystyrene (EPS) covered by a polycarbonate (PC) film - the purpose of which is to protect the EPS from splinters or minor damage, as well as to improve the aesthetics of the product - therefore the helmet may be penetrated by sharp objects.
8. Some SPIUK helmet models are supplied with a visor. While the visor itself does not offer extra impact protection, it does not impair its safety performance either.
9. We suggest that you replace your helmet three years after purchasing it or if it does not fit properly.
10. Prevention is the best way to guarantee safety. Take precautions to avoid accidents and follow traffic regulations.
11. For your safety, do not add or modify any part of the helmet, no matter how small the change. Also, do not replace any parts unless you use original parts supplied by the manufacturer and always follow the instructions in this manual to carry out the replacement.

Your SPIUK helmet is covered by a warranty.

Your helmet comes with a two-year warranty from the date of purchase. The warranty does not cover damage caused by failure to properly follow the instructions for use. The warranty also does not cover defects caused by misuse, improper care and maintenance, neglect, modifications or uses not recommended by the manufacturer.

All warranties must be accompanied by this document duly stamped or dated. This may be accompanied by the purchase receipt, or by the corresponding sales or distributor stamp.

Your SPIUK helmet will only do its job if it is in perfect condition.

Heat: Never expose the helmet to direct or indirect sources of heat. If the helmet structure deteriorates - deforms or melts - as a result of exposure to heat, this will not be covered by SPIUK's warranty. Do not use the helmet if the shell is deformed or melted.

Colour: Due to the use of environmentally friendly pigments, some colours may fade over time. This does not imply that the product is defective, nor does it imply a loss of the physical and safety qualities of the helmet.

Cleaning: To keep the helmet clean, simply wipe it with a cloth soaked in soap and water. Do not use solvent-based products, detergents or abrasive agents, as they can cause invisible damage to your helmet.

Expiration: In general, the helmet should be replaced every three years of use, as its components lose their qualities over time.

Visor

Some SPIUK helmet models are supplied with a visor. While the visor itself does not offer extra impact protection, it does not impair its safety performance either.

To attach the visor, position the inserts over the side holes or housings in the helmet shell and press until you hear a 'click' sound. To remove the visor, carefully pull the side ends until they release from the sockets.

Pads

All helmets come with standard pads with Velcro that can be easily removed and replaced. Please contact your dealer, supplier or distributor for spare parts.

When washing the pads, please follow the tips below and place them in a washing machine bag to avoid their loss:



Caps, helmet covers and other warm garments

Specific textile head coverings and helmets may be worn, provided that safety and visibility are not compromised. While the visor itself does not offer extra impact protection, it does not affect the safety performance of the helmet either.

The helmet must be securely fastened, and excessive forwards or backwards movement should not be possible. If this is not the case, discard the garment.

Your SPIUK helmet will work properly only if it fits properly.

The helmet must be securely fastened, and excessive forwards or backwards movement should not be possible. In addition, you should feel the strap press firmly against your chin when you open your mouth. To ensure a correct fit, four aspects must be considered:

1. Helmet position
2. Adjustment of the straps under the ears
3. Adjustment of the straps under the chin
4. Rear adjustment

1. Helmet position

First position the helmet so that the front and rear are aligned horizontally, as shown in **Diagrams 1, 2 and 3**:



Diagram 1

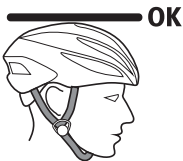

Diagram 2



Diagram 3

2. Adjustment of the straps under the ears

The straps should never cover the ears, as shown in **Diagram 2**, and the side dividers (the plastic pieces) should be positioned just below the ears. To adjust the length of the straps, first identify which divider system your helmet is equipped with: ARROWHEAD or QUICK DIVIDER.

ARROWHEAD

This system allows precise, aerodynamic and permanent adjustment. **Diagrams 4** and **5** describe the steps to be followed for adjustment. The example shows the outer side of the right ear:

..... Not Visible
— Visible

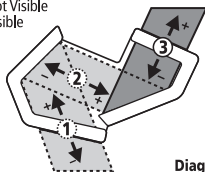

Diagram 4

Front strap adjustment. Pull the strap in the order shown (1>2>3) to extend (+), or in the reverse order (3>2>1) to reduce (-) the length.

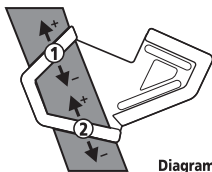

Diagram 5

Rear strap adjustment. Pull the strap in the order shown (1>2) to extend (+), or in the reverse order (2>1) to reduce (-) the length.

QUICK DIVIDER

This system allows quick and easy adjustment, but its position must be checked periodically. To adjust the length of the straps simply pull them in the desired direction.

3. Adjustment of chin straps

Close the chin buckle and tighten the straps until it feels comfortable and secure. You should feel the strap press firmly against your chin when you open your mouth. Fasten the excess ends of the straps with the rubber 'O' ring.

Some models are equipped with the automatic FIDLOCK® magnetic locking system, which can be operated with one hand. **Diagram 6** shows the position of the elements for automatic locking. **Diagram 7** shows the direction of pressure to open your FIDLOCK® system:

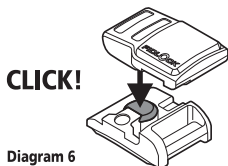

Diagram 6

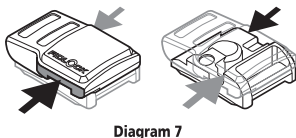

Diagram 7

4. Rear adjustment

Finally, the rear restraint system must be adjusted. SPIUK has several rear wheel adjustment systems. To tighten the system, turn the wheel to the right until the helmet is secure and comfortable. To loosen the system, turn the wheel to the left.

Some models are equipped with the BOA® adjustment system. This system works similarly but allows a more precise millimetric adjustment.

Some models also provide adjustment of the height of the rear adjustment system (**Diagram 8**). First identify which type of helmet restraint system your unit is equipped with, pin (**Diagram 9**) or slide (**Diagram 10**) and choose the desired position for a secure fit without discomfort.

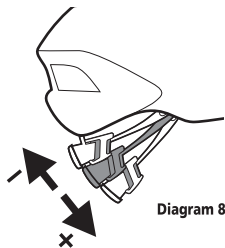

Diagram 8

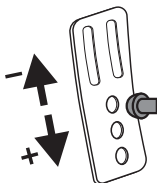

Diagram 9

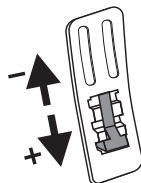

Diagram 10